

Stainless-Steel Pointed Shower Drain

Common pointed shower drains are made of plastic, which does not have a variety of designs, and also after a while, it will change color and become difficult to clean. Stainless-steel pointed shower drains have a variety of designs and dimensions and are easy to clean and resistant to chemicals. These products have a beautiful and luxurious appearance and are available in matte or scratched covers, ceramic and stone insert. Tecnomedex has manufactured this type of shower drain in different dimensions and sizes, the specifications of which are described in the table below. Our company has the ability to manufacture ceramic or stone insert point shower drain with special dimensions and in accordance with the request of our esteemed customers.



Pointed Shower Drain with Grate

PC2010s	PC1510s	PC1210s	PC1010s	Code
20x20	15x15	12x12	10x10	d - dimension (cm)
23	23	23	23	H - height (mm)
51 mm				Ø - outlet thickness
1.5 mm				t - thickness
Stainless-Steel 304 L				material

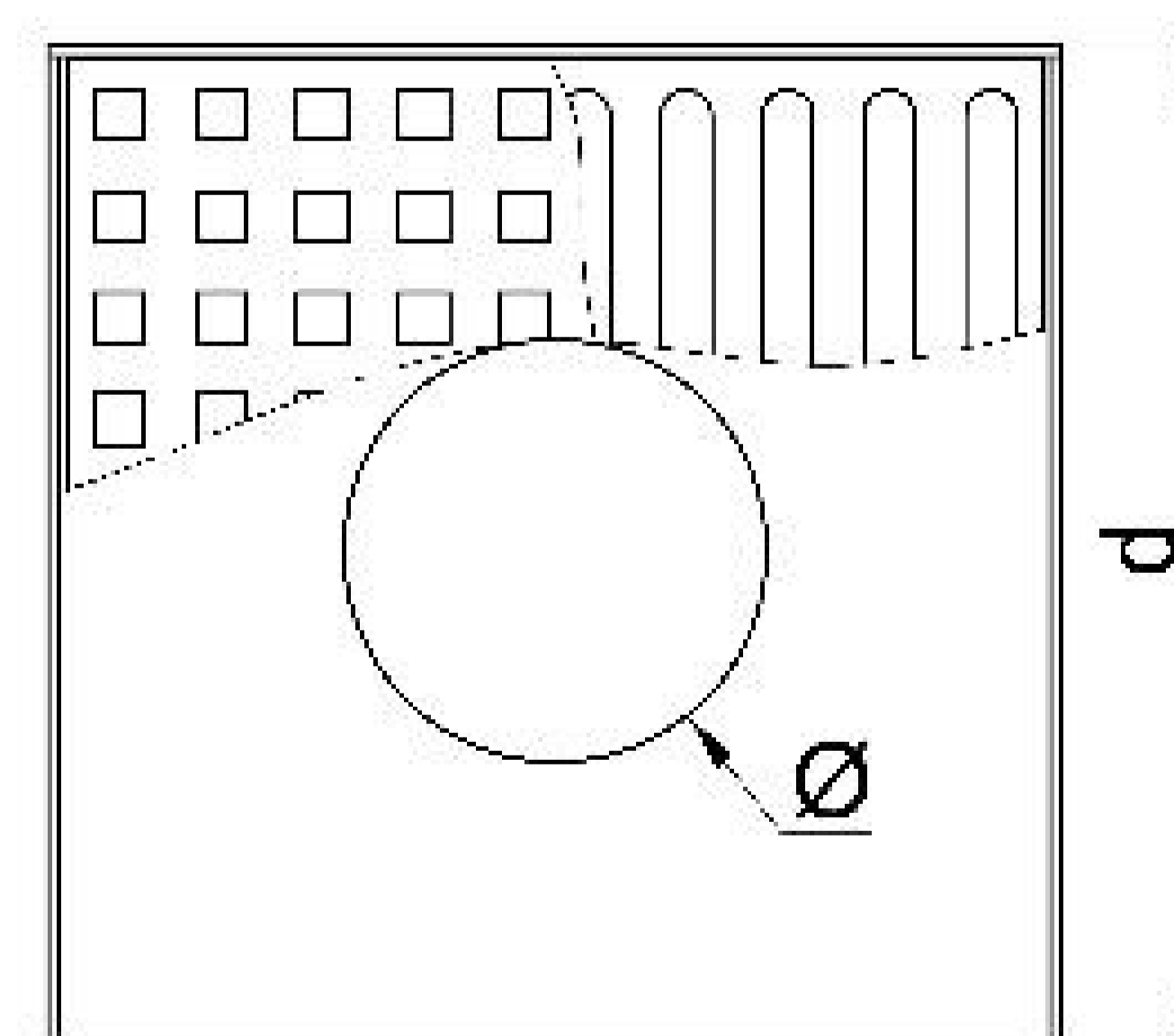
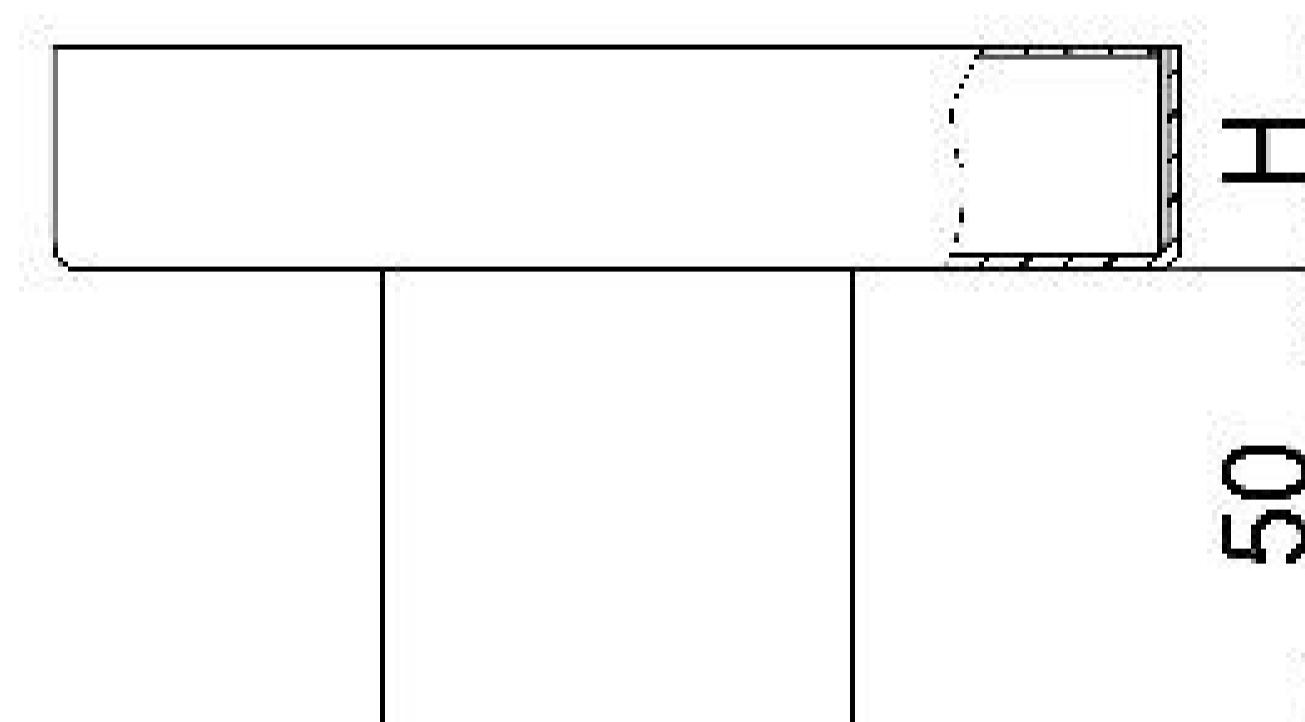

Pointed Shower Drain with Ceramic Insert

PT2011s	PT1511s	PT1211s	PT1011s	Code
20x20	15x15	12x12	10x10	d - dimension (cm)
23	23	23	23	H - height (mm)
11				D - depth (mm)
51 mm				Ø - outlet thickness
1.5 mm				t - thickness
Stainless-Steel 304 L				material

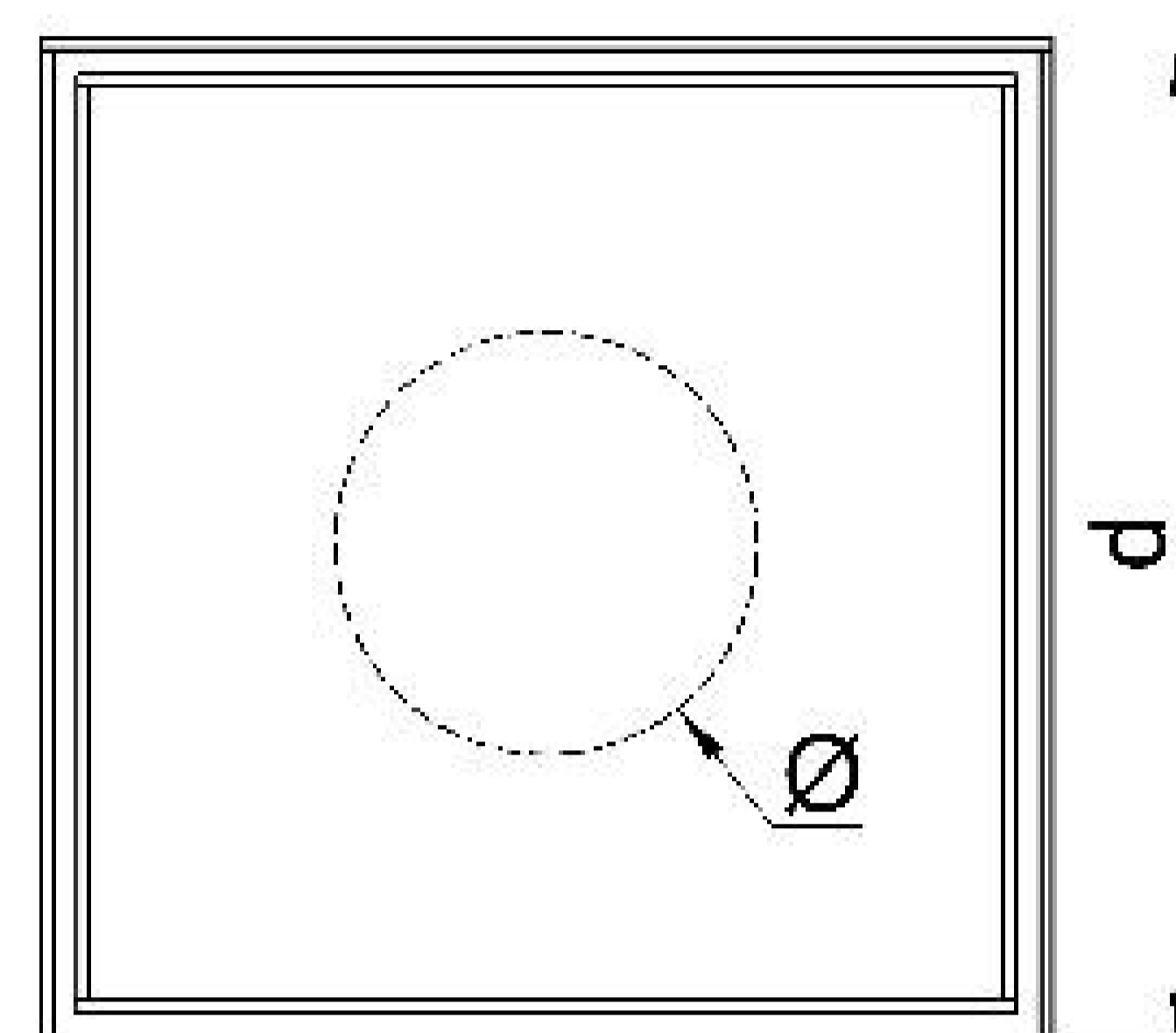
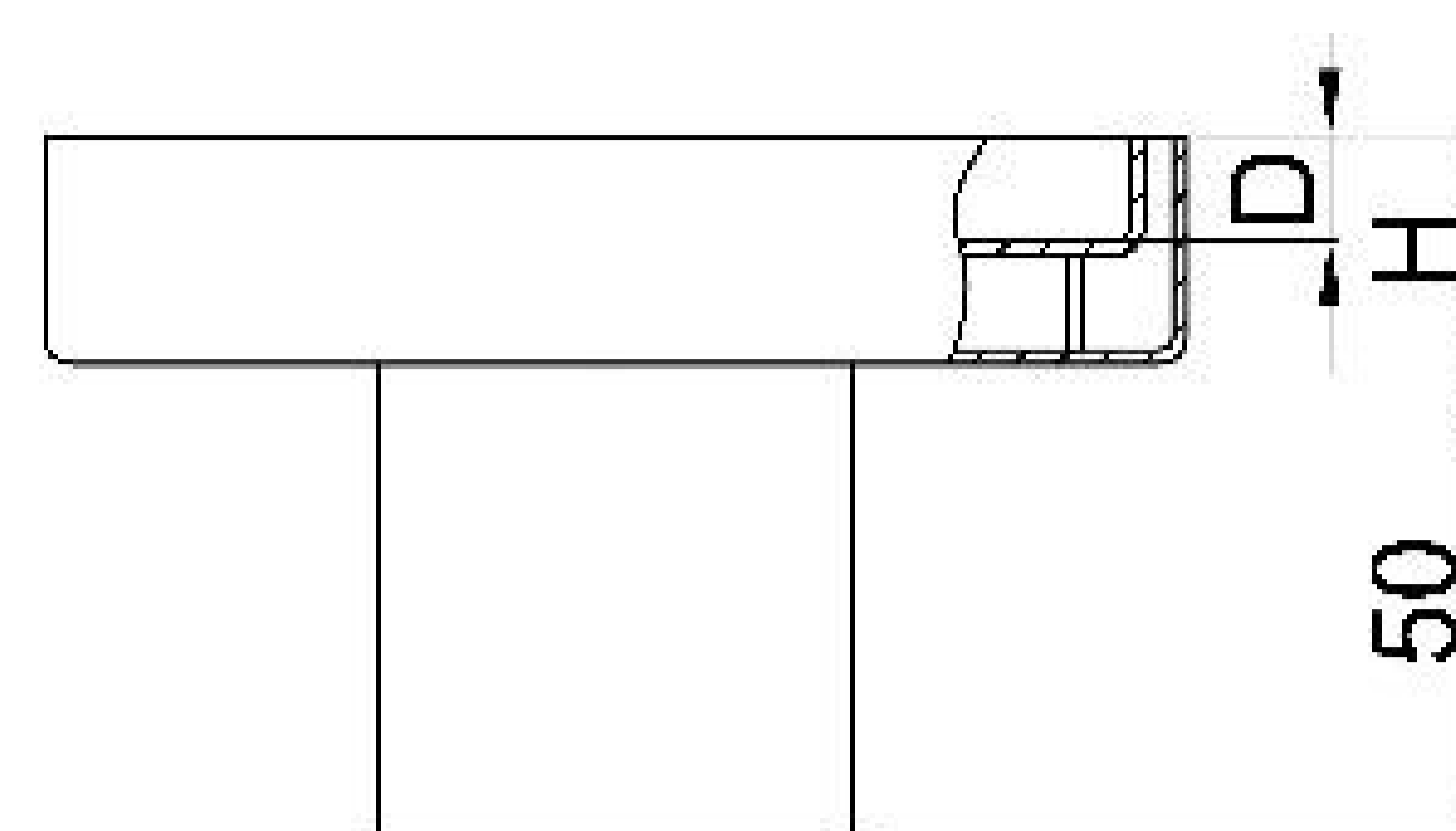

Pointed Shower Drain with Stone Insert

PS2022s	PS1522s	PS1222s	PS1022s	Code
20x20	15x15	12x12	10x10	d - dimension (cm)
35	35	35	35	H - height (mm)
22				D - depth (mm)
51 mm				Ø - outlet thickness
1.5 mm				t - thickness
Stainless-Steel 304 L				material

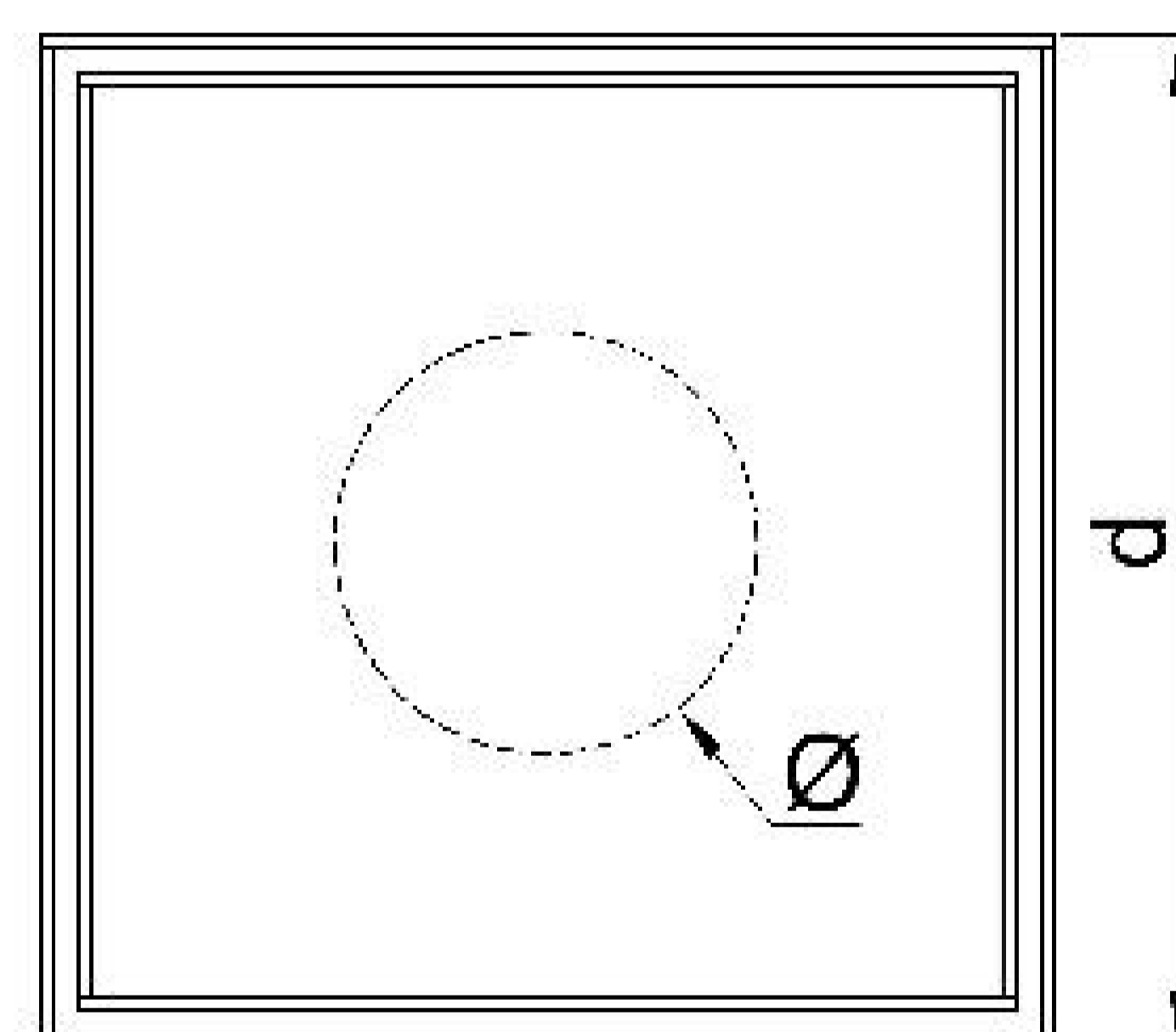
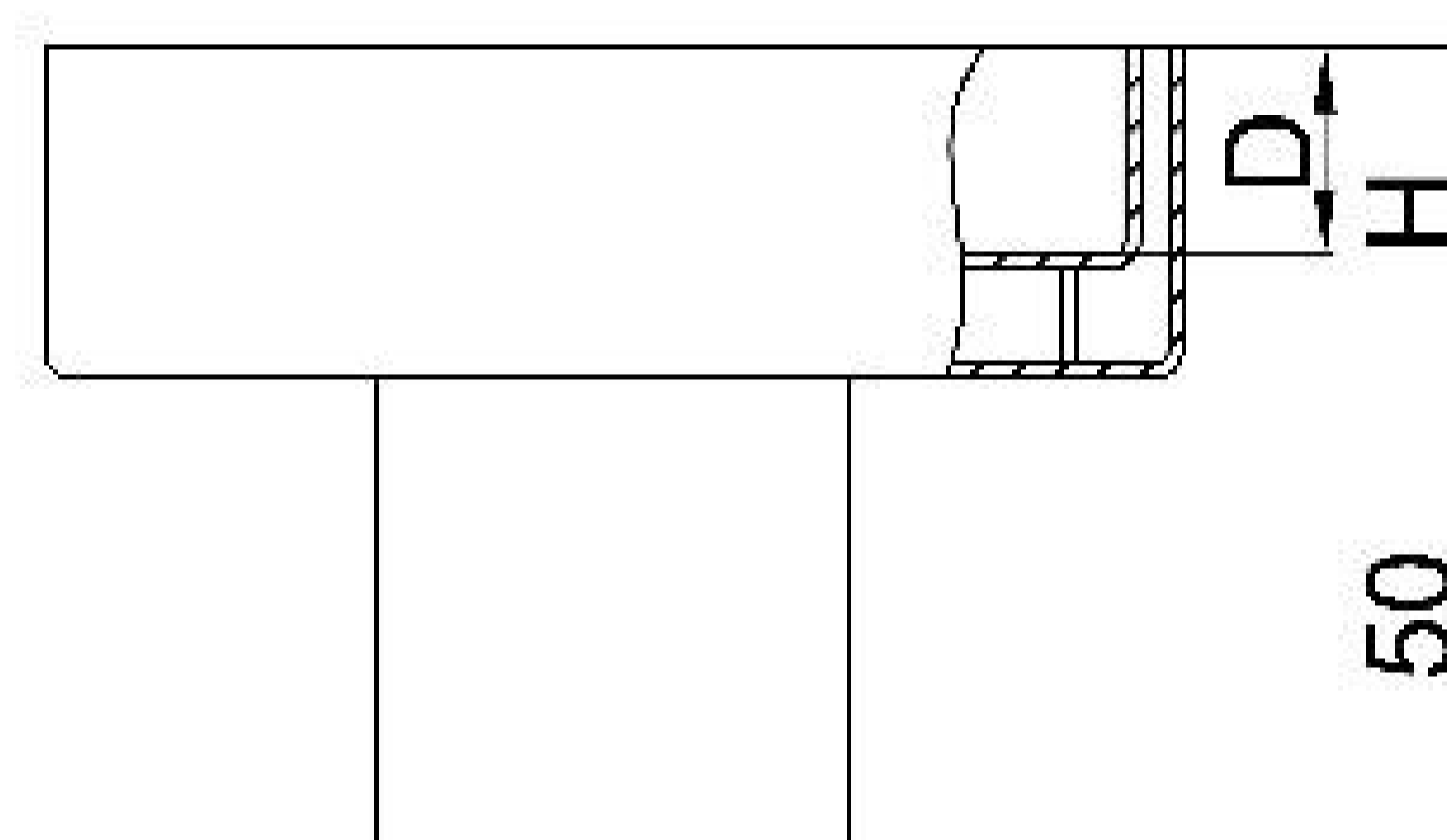

One-way poppet valve prevents insect entry and bad order



Hook for ease of removing cover

